

A417 Missing Link
TR010056

2.4 Works Plans
(Rev 1)

Planning Act 2008

APFP Regulation 5(2)(j)
Infrastructure Planning (Applications: Prescribed Forms and
Procedure) Regulations 2009

Volume 2

October 2021

Infrastructure Planning

Planning Act 2008

**The Infrastructure Planning
(Applications: Prescribed Forms
and Procedure) Regulations 2009**

A417 Missing Link

Development Consent Order 202[x]

2.4 Works Plans

Regulation Number:	5(2)(j)
Planning Inspectorate scheme Reference	TR010056
Application Document Reference	2.4
Author:	A417 Missing Link

Version	Date	Status of Version
C01	May 2021	Application Submission
C02	October 2021	Procedural Deadline A

Contents

1. 2.4 Works Plans APFP Regulations 5(2)(j) Keyplan (C02)
2. 2.4 Works Plans APFP Regulations 5(2)(j) - Sheet 1 of 6 (C02)
3. 2.4 Works Plans APFP Regulations 5(2)(j) - Sheet 2 of 6 (C02)
4. 2.4 Works Plans APFP Regulations 5(2)(j) - Sheet 3 of 6 (C02)
5. 2.4 Works Plans APFP Regulations 5(2)(j) - Sheet 4 of 6 (C02)
6. 2.4 Works Plans APFP Regulations 5(2)(j) - Sheet 5 of 6 (C02)
7. 2.4 Works Plans APFP Regulations 5(2)(j) - Sheet 6 of 6 (C02)

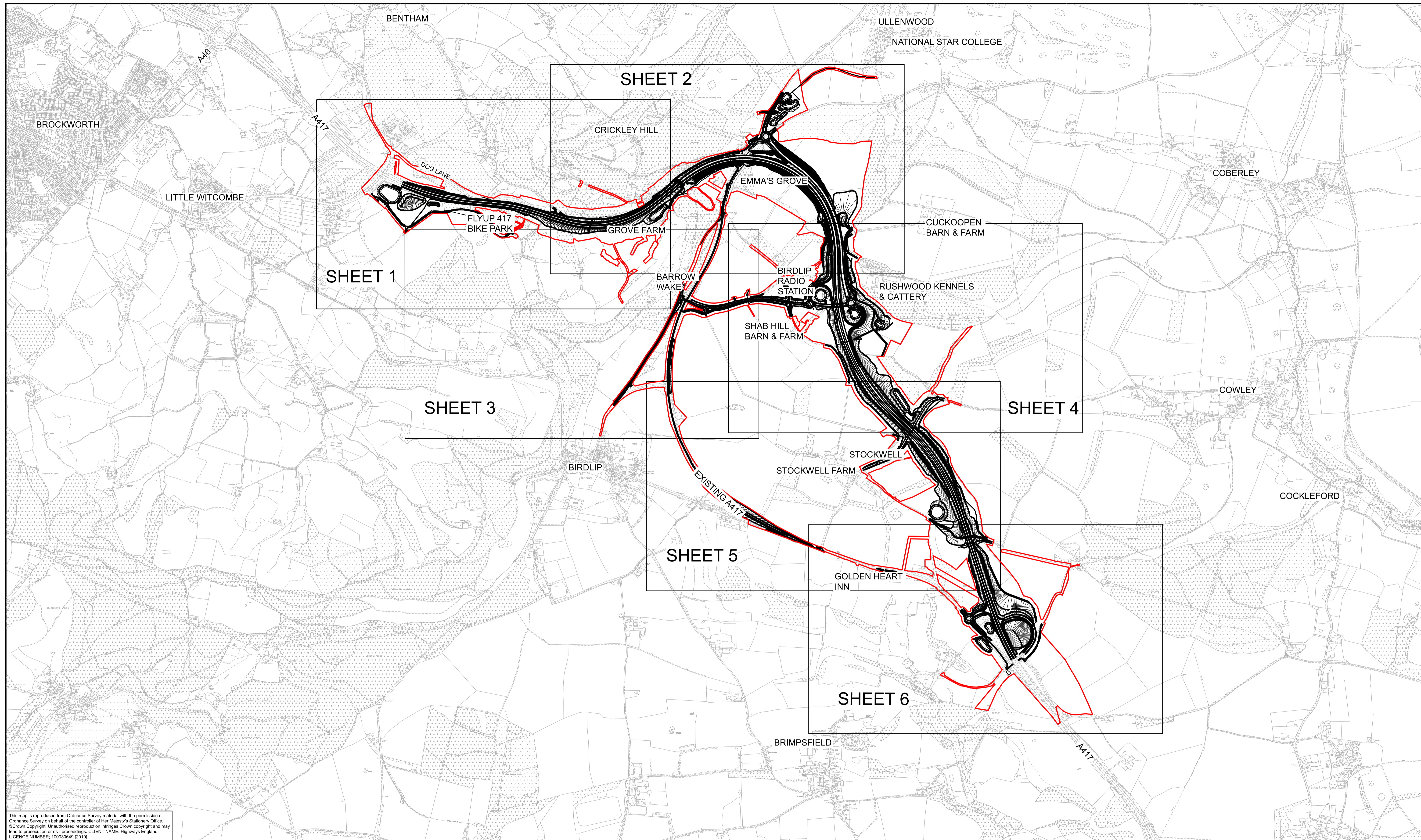

This map is reproduced from Ordnance Survey material with the permission of Ordnance Survey on behalf of the controller of Her Majesty's Stationery Office. © Crown Copyright. Unauthorised reproduction infringes Crown copyright and may lead to prosecution or civil proceedings. CLIENT NAME: Highways England LICENCE NUMBER: 100030649 (2019)

NOTES
1. ALL DIMENSIONS ARE IN METRES UNLESS NOTED OTHERWISE.

LEGEND
— DEVELOPMENT CONSENT ORDER BOUNDARY

Rev.	Date	Description	By	Chk'd	App'd	Auth'd
C02	20/10/21	PROCEDURAL DEADLINE A	ES	DA	DB	YB

Suitability: A3 | Drawing Status: STAGE COMPLETED

Project Title: A417 MISSING LINK

Drawing Title: WORKS PLANS
APFP REGULATIONS 5(2)(j)
KEY PLAN
APPLICATION NUMBER: TR010056

Scale	By	Checked	Approved	Authorised
1:10000	ES	DA	DB	YB
Original Size	Date	Date	Date	Date
A1	20/10/21	20/10/21	20/10/21	20/10/21

Client:

Drawing Number	Originator	Volume	Revision
HE551505 - X_XX_XXXX_X	ARP - DR - ZL	LSI - 000400	C02

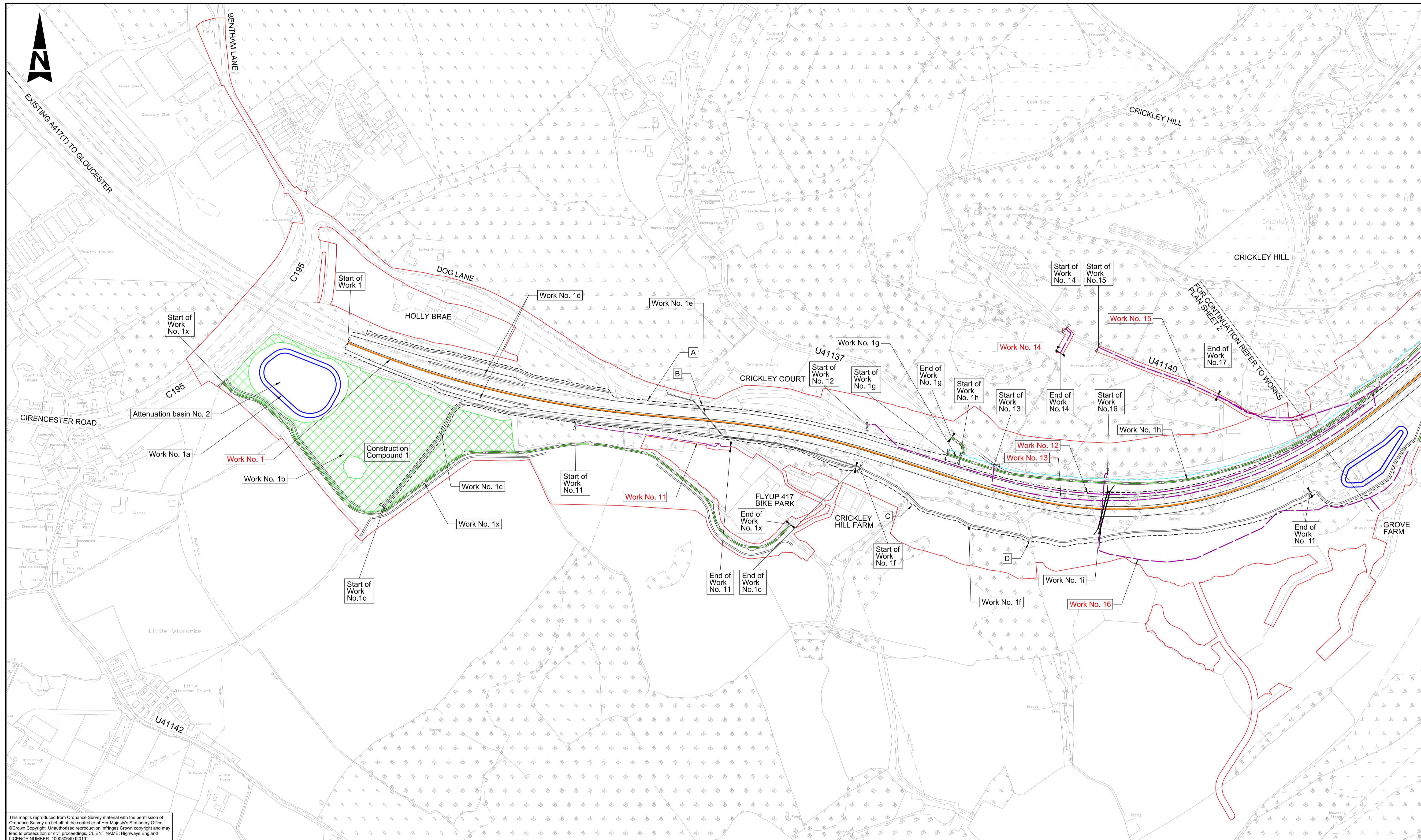

This map is reproduced from Ordnance Survey material with the permission of Ordnance Survey on behalf of the controller of Her Majesty's Stationery Office. © Crown Copyright. Unauthorised reproduction infringes Crown copyright and may lead to prosecution or civil proceedings. CLIENT NAME: Highways England LICENCE NUMBER: 100030649 (2019)

- NOTES**
- ALL DIMENSIONS ARE IN METRES UNLESS NOTED OTHERWISE.
- LEGEND:**
- DEVELOPMENT CONSENT ORDER BOUNDARY
 - A417 MAINLINE CENTRELINE
 - A417 MAINLINE EARTHWORKS (INCLUDING 2.0M LATERAL DEVIATION)
 - SIDE ROAD, JUNCTION AND SLIP ROAD CENTRELINE
 - SIDE ROAD EARTHWORKS (INCLUDING 2.0M LATERAL DEVIATION)
 - EXTENT OF CARRIAGEWAY (INDICATIVE)
 - UTILITY DIVERSION WORK CENTRELINE
 - PARISH BOUNDARY
 - CONSTRUCTION COMPOUND
 - START OF LINEAR WORKS
 - END OF LINEAR WORKS
 - START AND END OF LINEAR WORKS
 - BOUNDARY SITE
 - DE-TRUNKING WORKS
 - DRAINAGE DITCH
 - CULVERT
 - ATTENUATION BASIN
 - MAMMAL CULVERT
 - U41140 UNCLASSIFIED ROAD REFERENCE NUMBER
 - LIMITS OF DEVIATION LABEL
 - START / END OF WORK NUMBER

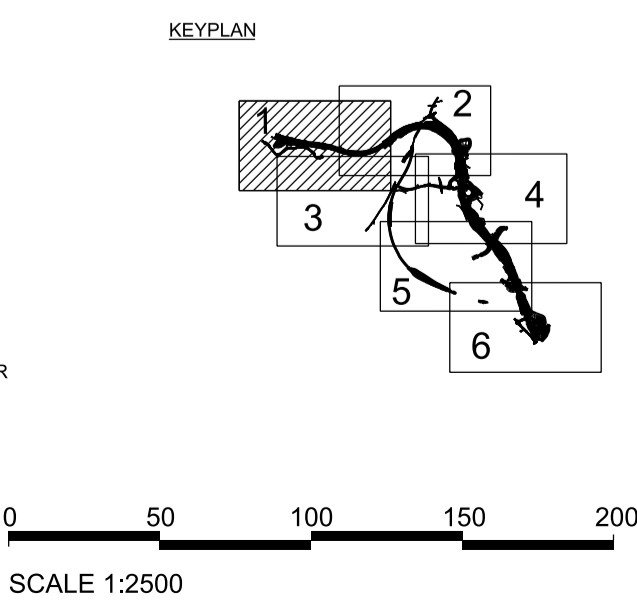

Rev.	Date	Description	By	Chk'd	App'd	Auth'd
C02	20/10/21	PROCEDURAL DEADLINE A	ES	DA	DB	YB

Suitability: **A3** | Drawing Status: **STAGE COMPLETED**

Client:

Project Title: A417 MISSING LINK					
Drawing Title: WORKS PLANS APPFP REGULATIONS 5(2)(j) SHEET 1 OF 6 APPLICATION NUMBER: TR010056					
Scale: 1:2500	By: ES	Checked: DA	Approved: DB	Authorised: YB	
Original Size: A1	Date: 20/10/21	Date: 20/10/21	Date: 20/10/21	Date: 20/10/21	Date: 20/10/21
Drawing Number: HE551505 - X_XX_XXXX_X	Originator: - ARP	Volume: - LSI	Number: -DR-ZL-000401		Revision: C02

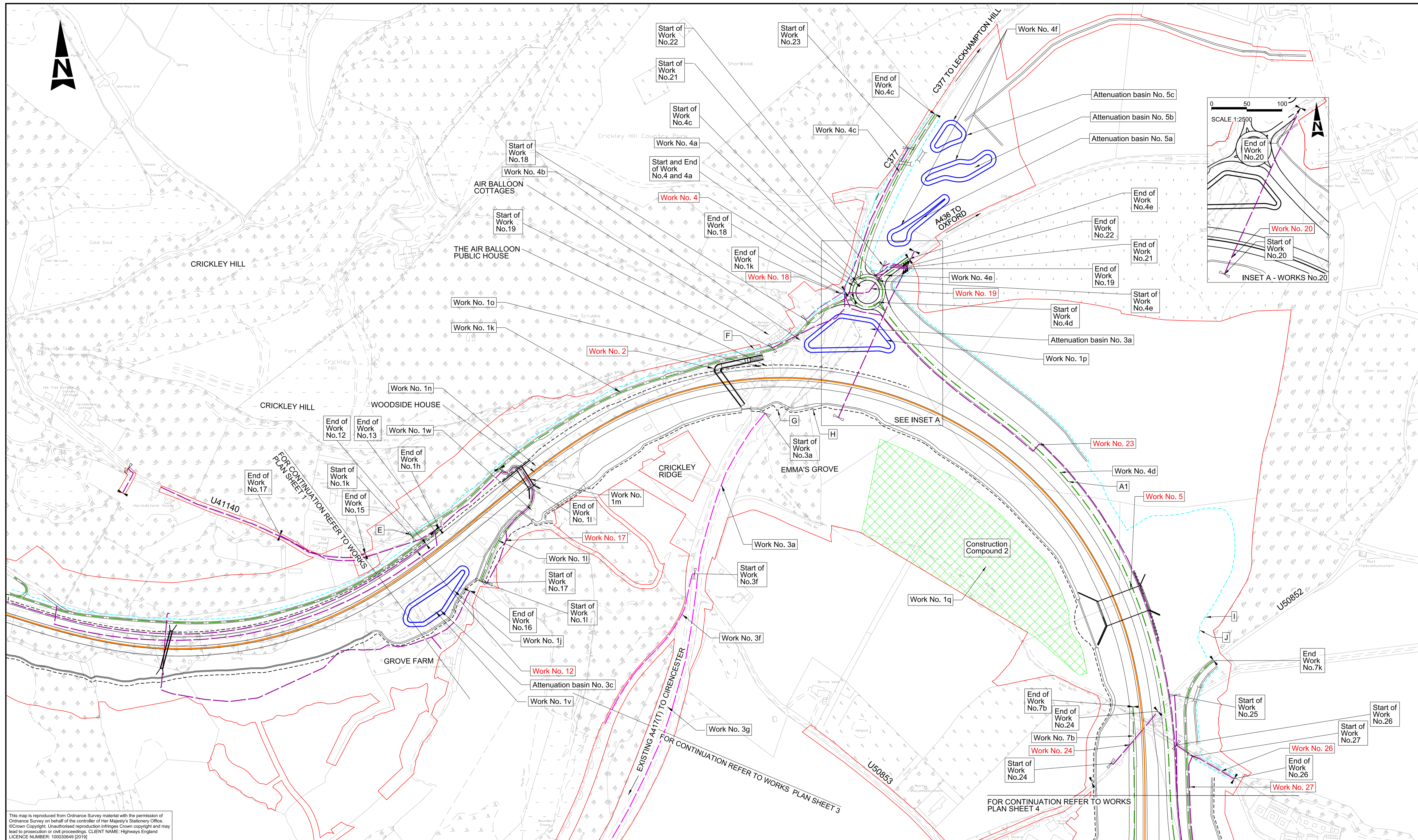

This map is reproduced from Ordnance Survey material with the permission of Ordnance Survey on behalf of the controller of Her Majesty's Stationery Office. © Crown Copyright. Unauthorised reproduction infringes Crown copyright and may lead to prosecution or civil proceedings. CLIENT NAME: Highways England LICENCE NUMBER: 100030649 (2019)

- NOTES**
1. ALL DIMENSIONS ARE IN METRES UNLESS NOTED OTHERWISE.
- LEGEND:**
- DEVELOPMENT CONSENT ORDER BOUNDARY
 - A417 MAINLINE CENTRELINE
 - A417 MAINLINE EARTHWORKS (INCLUDING 2.0M LATERAL DEVIATION)
 - SIDE ROAD, JUNCTION AND SLIP ROAD CENTRELINE
 - SIDE ROAD EARTHWORKS (INCLUDING 2.0M LATERAL DEVIATION)
 - EXTENT OF CARRIAGEWAY (INDICATIVE)
 - UTILITY DIVERSION WORK CENTRELINE
 - PARISH BOUNDARY
 - CONSTRUCTION COMPOUND
 - START OF LINEAR WORKS
 - END OF LINEAR WORKS
 - START AND END OF LINEAR WORKS
 - BOUNDARY SITE
 - DE-TRUNKING WORKS
 - DRAINAGE DITCH
 - CULVERT
 - MAMMAL CULVERT
 - U41140 UNCLASSIFIED ROAD REFERENCE NUMBER
 - LIMITS OF DEVIATION LABEL
 - START / END OF WORK NUMBER

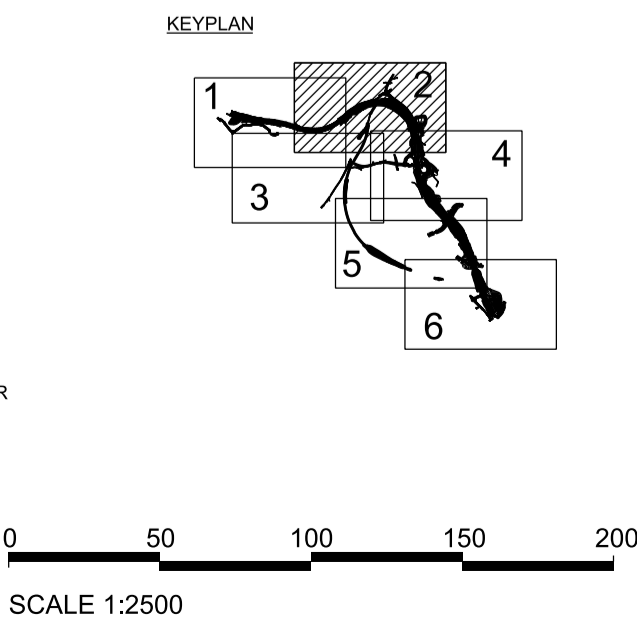

Rev.	Date	Description	By	Chk'd	App'd	Auth'd
C02	20/10/21	PROCEDURAL DEADLINE A	ES	DA	DB	YB

Suitability	Drawing Status	Project Title		
A3	STAGE COMPLETED	A417 MISSING LINK		
Drawing Title				
WORKS PLANS APPFP REGULATIONS 5(2)(j) SHEET 2 OF 6 APPLICATION NUMBER: TR010056				
Scale	By	Checked	Approved	Authorised
1:2500	ES	DA	DB	YB
Original Size	Date	Date	Date	Date
A1	20/10/21	20/10/21	20/10/21	20/10/21
Drawing Number	HE PIN	Originator	Volume	Revision
HE551505 -	ARP	LSI		C02
X_XX_XXXX_X	-DR - ZL	-000402		
Location	Type	Role	Number	



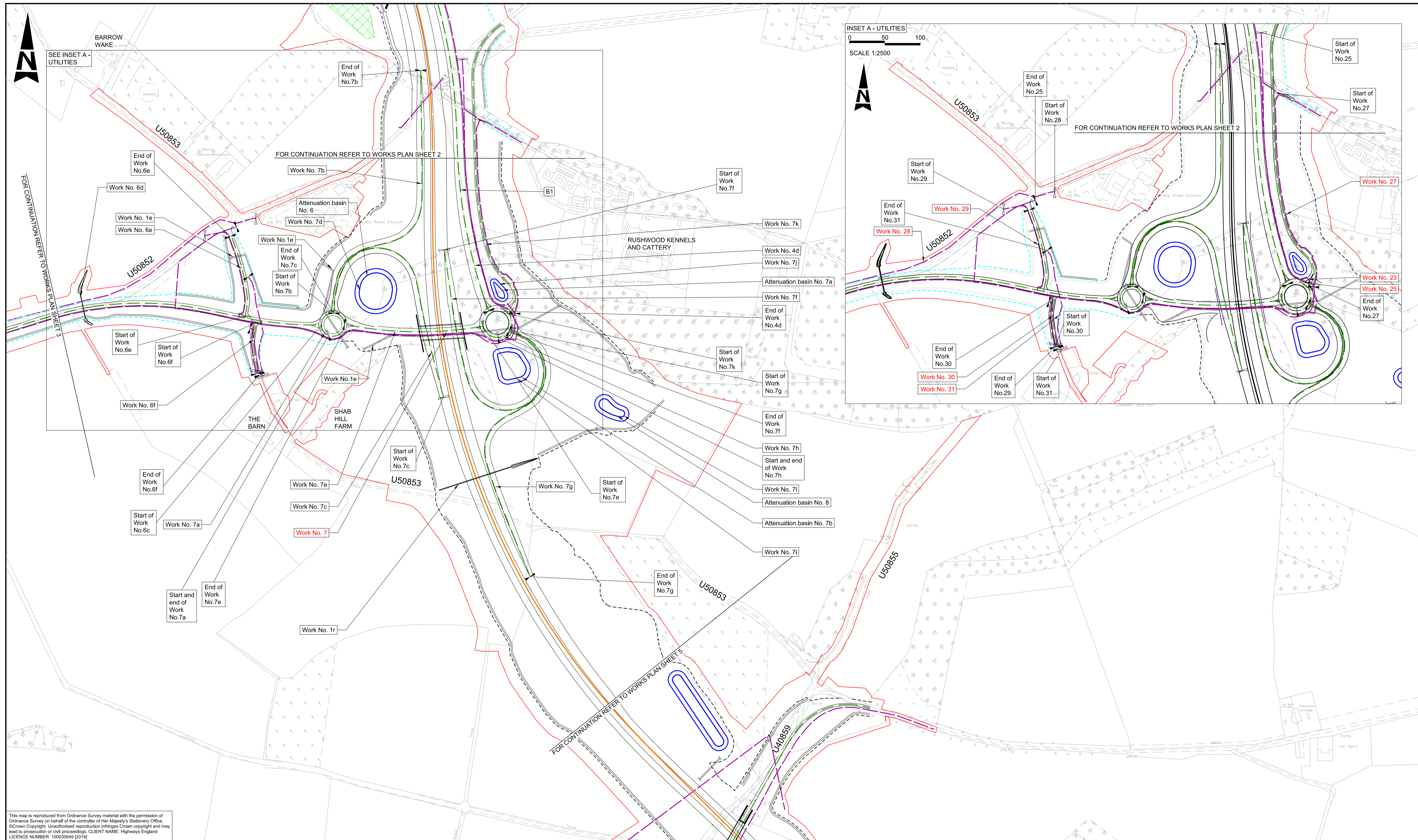

INSET A - UTILITIES
SCALE 1:2500

This map is reproduced from Ordnance Survey material with the permission of Ordnance Survey on behalf of the controller of Her Majesty's Stationery Office. © Crown Copyright. Unauthorised reproduction infringes Crown copyright and may lead to prosecution or civil proceedings. CLIENT NAME: Highways England LICENCE NUMBER: 100030649 (2019)

- NOTES**
1. ALL DIMENSIONS ARE IN METRES UNLESS NOTED OTHERWISE.
- LEGEND:**
- DEVELOPMENT CONSENT ORDER BOUNDARY
 - A417 MAINLINE CENTRELINE
 - A417 MAINLINE EARTHWORKS (INCLUDING 2.0M LATERAL DEVIATION)
 - SIDE ROAD, JUNCTION AND SLIP ROAD CENTRELINE
 - SIDE ROAD EARTHWORKS (INCLUDING 2.0M LATERAL DEVIATION)
 - EXTENT OF CARRIAGEWAY (INDICATIVE)
 - UTILITY DIVERSION WORK CENTRELINE
 - PARISH BOUNDARY
 - CONSTRUCTION COMPOUND
 - START OF LINEAR WORKS
 - END OF LINEAR WORKS
 - START AND END OF LINEAR WORKS
 - BOUNDARY SITE
 - DE-TRUNKING WORKS
 - DRAINAGE DITCH
 - CULVERT
 - ATTENUATION BASIN
 - MAMMAL CULVERT
 - U41140 UNCLASSIFIED ROAD REFERENCE NUMBER
 - LIMITS OF DEVIATION LABEL
 - START / END OF WORK NUMBER

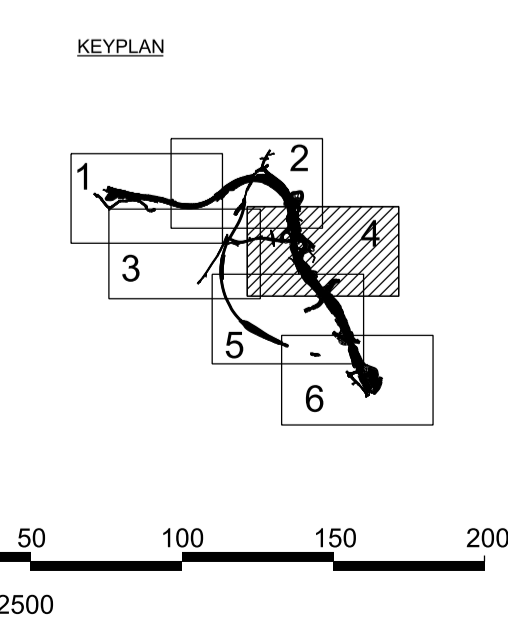

Rev.	Date	Description	By	Chk'd	App'd	Auth'd
C02	20/10/21	PROCEDURAL DEADLINE A	ES	DA	DB	YB

Suitability	Drawing Status
A3	STAGE COMPLETED

Project Title						A417 MISSING LINK					
Drawing Title						WORKS PLANS APFP REGULATIONS 5(2)(j) SHEET 4 OF 6 APPLICATION NUMBER: TR010056					
Scale	1:2500	By	ES	Checked	DA	Approved	DB	Authorised	YB		
Original Size	A1	Date	20/10/21	Date	20/10/21	Date	20/10/21	Date	20/10/21		
Drawing Number	HE PIN	Originator	ARP	Volume	LSI	Location	-DR -ZL -000404	Type	Role	Number	C02

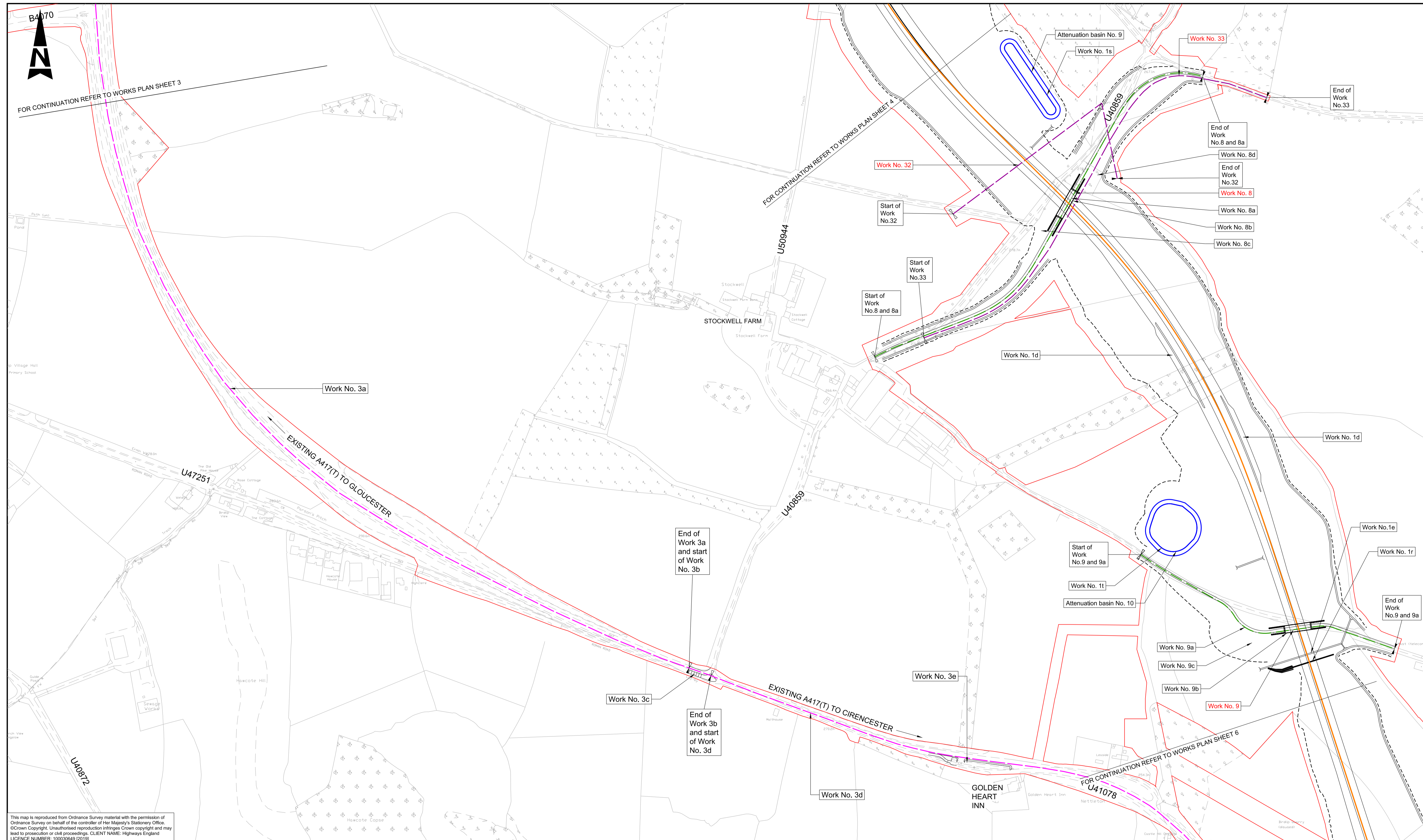

This map is reproduced from Ordnance Survey material with the permission of Ordnance Survey on behalf of the controller of Her Majesty's Stationery Office. © Crown Copyright. Unauthorised reproduction infringes Crown copyright and may lead to prosecution or civil proceedings. CLIENT NAME: Highways England LICENCE NUMBER: 100030649 (2019)

- NOTES**
1. ALL DIMENSIONS ARE IN METRES UNLESS NOTED OTHERWISE.
- LEGEND:**
- DEVELOPMENT CONSENT ORDER BOUNDARY
 - A417 MAINLINE CENTRELINE
 - A417 MAINLINE EARTHWORKS (INCLUDING 2.0M LATERAL DEVIATION)
 - SIDE ROAD, JUNCTION AND SLIP ROAD CENTRELINE
 - SIDE ROAD EARTHWORKS (INCLUDING 2.0M LATERAL DEVIATION)
 - EXTENT OF CARRIAGEWAY (INDICATIVE)
 - UTILITY DIVERSION WORK CENTRELINE
 - PARISH BOUNDARY
 - CONSTRUCTION COMPOUND
 - START OF LINEAR WORKS
 - END OF LINEAR WORKS
 - START AND END OF LINEAR WORKS
 - BOUNDARY SITE
 - DE-TRUNKING WORKS
 - DRAINAGE DITCH
 - CULVERT
 - ATTENUATION BASIN
 - MAMMAL CULVERT
 - U41140 UNCLASSIFIED ROAD REFERENCE NUMBER
 - LIMITS OF DEVIATION LABEL
 - START / END OF WORK NUMBER

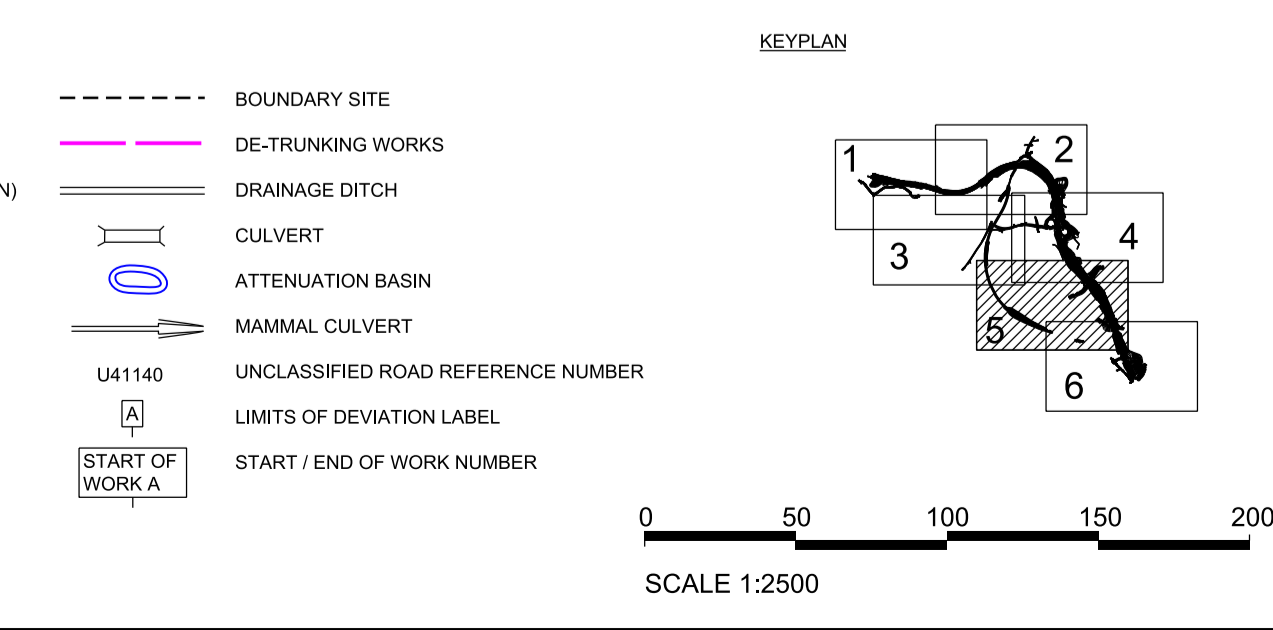

CO2	20/10/21	PROCEDURAL DEADLINE A	ES	DA	DB	YB
Rev.	Date	Description	By	Chk'd	App'd	Auth'd

Suitability	Drawing Status
A3	STAGE COMPLETED
Client	

Project Title					
A417 MISSING LINK					
Drawing Title					
WORKS PLANS APFP REGULATIONS 5(2)(j) SHEET 5 OF 6 APPLICATION NUMBER: TR010056					
Scale	By	Checked	Approved	Authorised	
1:2500	ES	DA	DB	YB	
Original Size	Date	Date	Date	Date	Date
A1	20/10/21	20/10/21	20/10/21	20/10/21	20/10/21
Drawing Number	HE PIN	Originator	Volume	Revision	
HE551505 -	ARP	LSI	C02		
X_XX_XXXX_X	-DR	-ZL	-000405		
Location	Type	Role	Number		

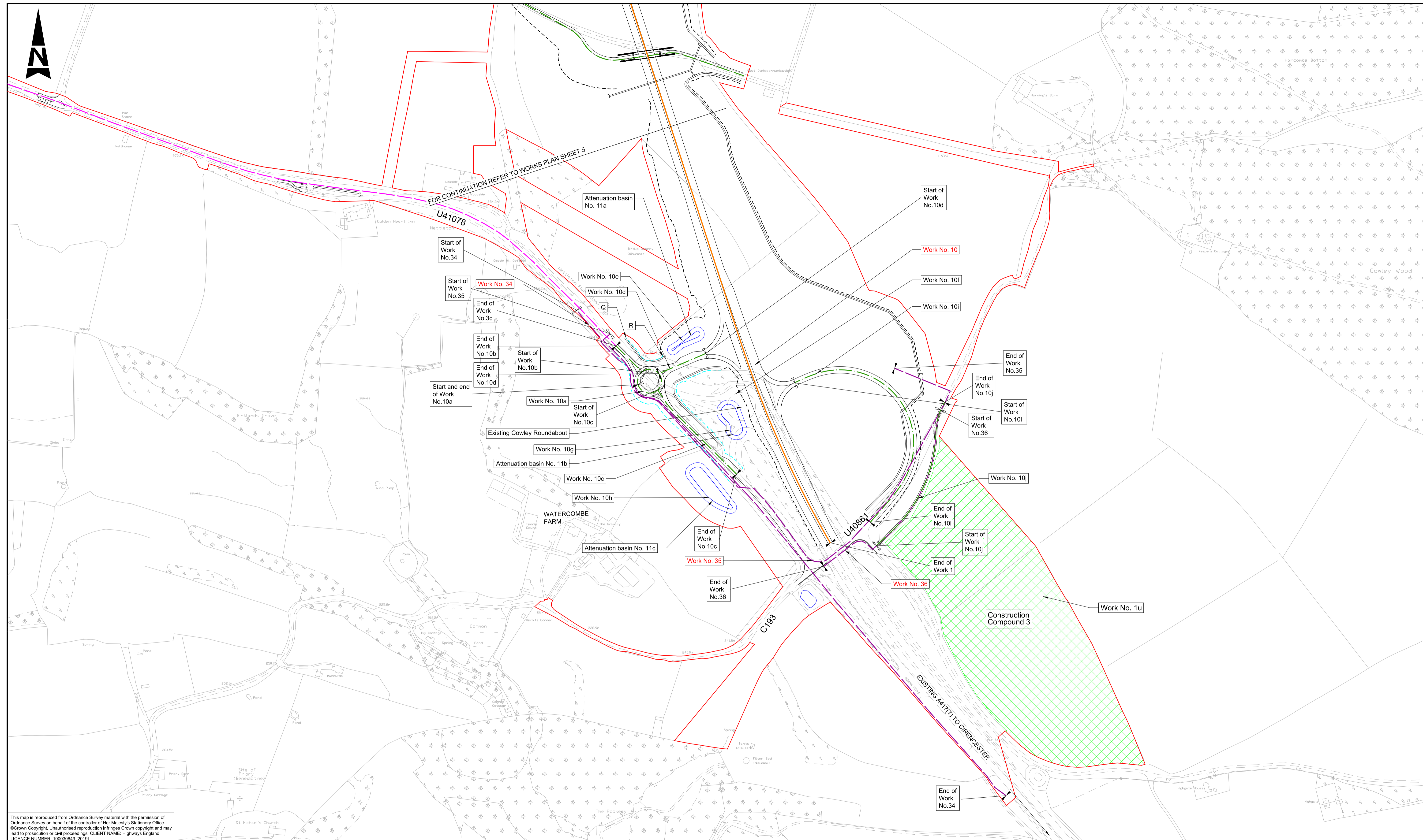

This map is reproduced from Ordnance Survey material with the permission of Ordnance Survey on behalf of the controller of Her Majesty's Stationery Office. © Crown Copyright. Unauthorised reproduction infringes Crown copyright and may lead to prosecution or civil proceedings. CLIENT NAME: Highways England LICENCE NUMBER: 100030649 (2019)

- NOTES**
1. ALL DIMENSIONS ARE IN METRES UNLESS NOTED OTHERWISE.
- LEGEND:**
- DEVELOPMENT CONSENT ORDER BOUNDARY
 - A417 MAINLINE CENTRELINE
 - A417 MAINLINE EARTHWORKS (INCLUDING 2.0M LATERAL DEVIATION)
 - SIDE ROAD, JUNCTION AND SLIP ROAD CENTRELINE
 - SIDE ROAD EARTHWORKS (INCLUDING 2.0M LATERAL DEVIATION)
 - EXTENT OF CARRIAGEWAY (INDICATIVE)
 - UTILITY DIVERSION WORK CENTRELINE
 - PARISH BOUNDARY
 - CONSTRUCTION COMPOUND
 - START OF LINEAR WORKS
 - END OF LINEAR WORKS
 - START AND END OF LINEAR WORKS
 - BOUNDARY SITE
 - DE-TRUNKING WORKS
 - DRAINAGE DITCH
 - CULVERT
 - ATTENUATION BASIN
 - MAMMAL CULVERT
 - U41140 UNCLASSIFIED ROAD REFERENCE NUMBER
 - LIMITS OF DEVIATION LABEL
 - START / END OF WORK NUMBER

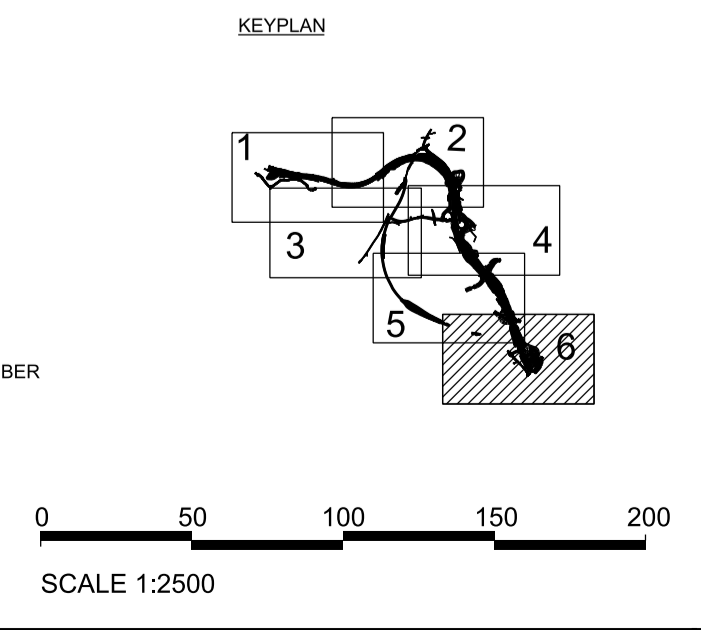

Rev.	Date	Description	By	Chk'd	App'd	Auth'd
C02	20/10/21	PROCEDURAL DEADLINE A	ES	DA	DB	YB

Suitability	Drawing Status
A3	STAGE COMPLETED

Project Title		A417 MISSING LINK			
Drawing Title		WORKS PLANS APFP REGULATIONS 5(2)(j) SHEET 6 OF 6 APPLICATION NUMBER: TR010056			
Scale	By	Checked	Approved	Authorised	
1:2500	ES	DA	DB	YB	
Original Size	Date	Date	Date	Date	
A1	20/10/21	20/10/21	20/10/21	20/10/21	
Drawing Number	HE PIN	Originator	Volume	Revision	
HE551505 - ARP	- LSI	- DR - ZL	-000406	C02	
X_XX_XXXX_X	-DR - ZL	-000406			
Location	Type	Role	Number		

